

## Tangential Air Separators

*Cemline TAS Series Tanks are designed to remove undesired, entrained air from heating/cooling hydronic systems.*

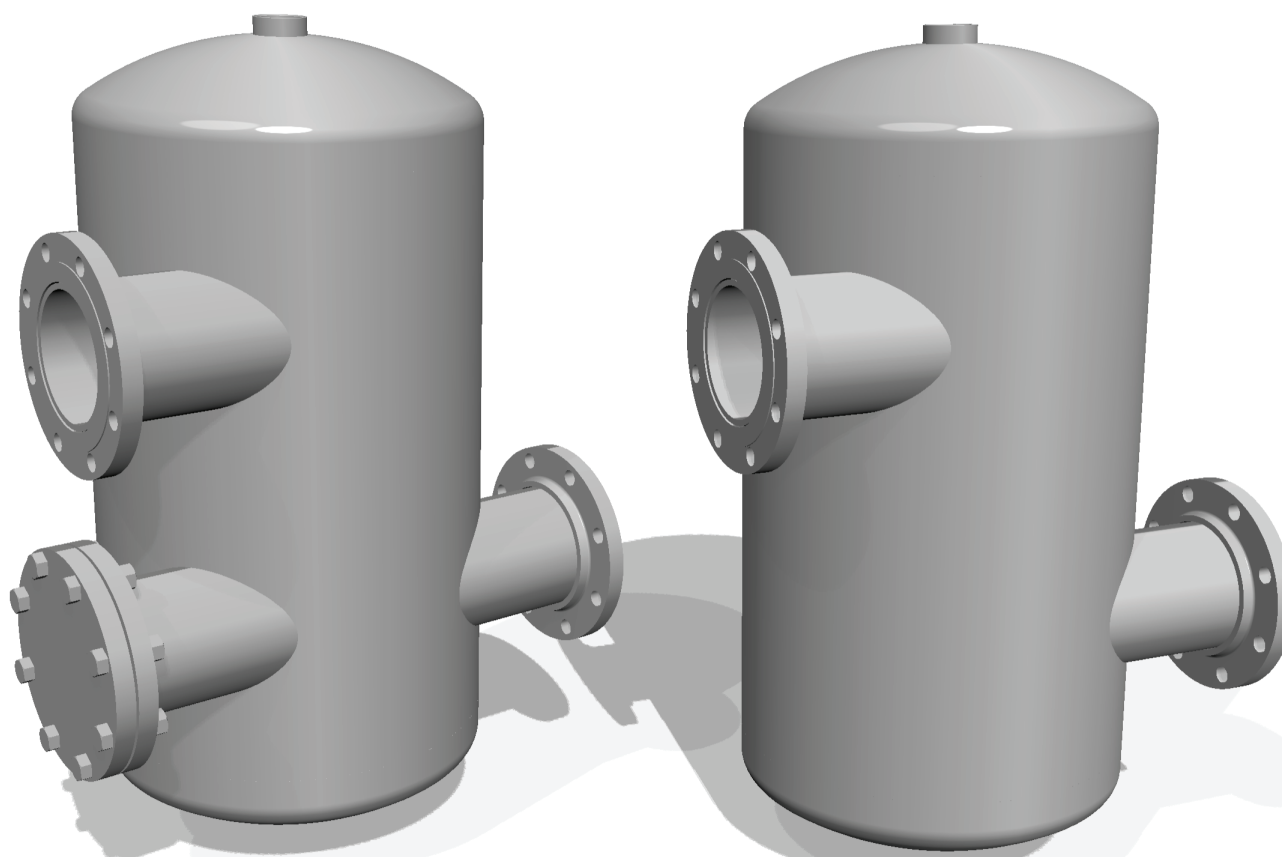

**Cemline Tangential Air Separators (TAS) extract air efficiently and rapidly from closed and open loop heating and cooling systems.**

Entrained air within the systems can cause unwanted noise, efficiency loss, or damage over time. Water enters the separator through a tangential port that creates a vortex within the

tank that encourages the dissolved or entrained air to separate from the water as microbubbles and exit through an air vent at the top of the tank. The denser, air-removed water sinks to the bottom of the tank and exits the unit.

The Separator can be supplied with an optional stainless steel strainer to

gather unwanted dirt and debris from the system.

### CEMLINE CORPORATION

P.O. BOX 55 CHESWICK, PENNSYLVANIA 15024  
Phone: (724) 274-5430 FAX: (724) 274-5448

[www.cemline.com](http://www.cemline.com)

# Cemline® Tangential Air Separators Specifications

## Standard Equipment

- A.S.M.E. Pressure vessel (carbon steel) rated for 125 psig @ 400°F built to A.S.M.E Section VIII, Division I.
- Mounting include leg stands, ring base, or hanging brackets.

## Optional Equipment

- Insulation
  - Chilled Water System - factory mounted elastomeric thermal insulation black in color ½" through 2".
  - Hot Water System - foam R-12.5 field installed insulation with removable jacket.
- Air Vent - Reduces air accumulation in the system.
- Stainless Steel A.S.M.E. pressure vessel.

## TAS without Strainer

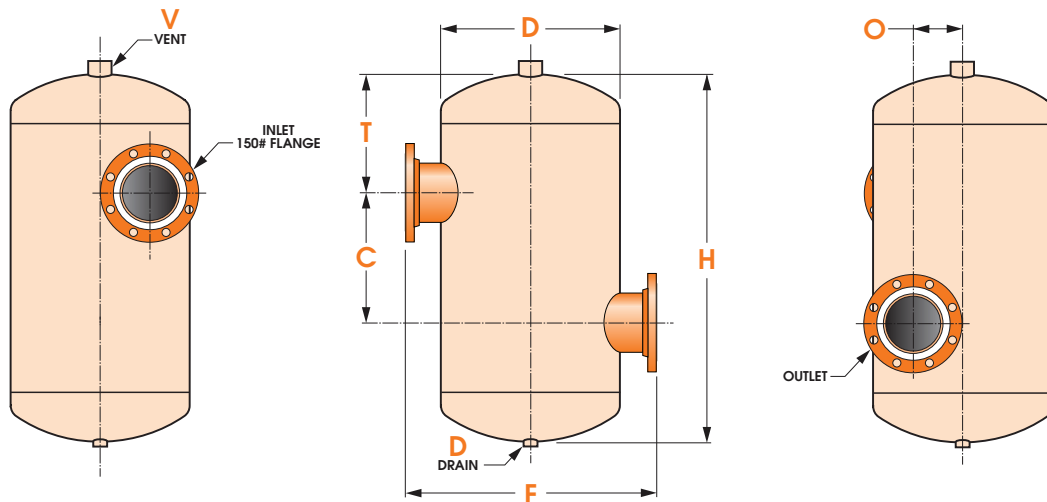

## Dimensional Chart

Model No.	In/Out	D	H	"F" Face to Face	"C" Center to Center	"T" Distance from Top to Center of Inlet	"O" Flange Offset from Center Line	"V" Vent	"D" Drain	Weight (lbs)
TAS-2-N-L	2"	12"	26"	18"	9"	8 1/2"	3 1/2"	1 1/4"	1"	40
TAS-2.5-N-L	2.5"	12"	26"	18"	9"	8 1/2"	3 1/2"	1 1/4"	1"	45
TAS-3-F-L	3"	12"	26"	20"	9"	8 1/2"	3 1/2"	1 1/4"	1"	70
TAS-4-F-L	4"	14"	30"	21"	10 3/4"	9 5/8"	4 1/4"	1 1/2"	1"	85
TAS-5-F-L	5"	16"	32"	24"	12"	10"	4 3/4"	1 1/2"	1"	115
TAS-6-F-L	6"	20"	41"	28"	14 1/2"	13 1/4"	5 1/2"	2"	1"	185
TAS-8-F-L	8"	24"	52"	32"	18"	17"	6 3/4"	2"	1"	220
TAS-10-F-L	10"	30"	60"	41"	22"	19"	8 7/16"	2"	1"	475
TAS-12-F-L	12"	30"	66"	41"	26"	20"	7 7/16"	2"	1"	600
TAS-14-F-L	14"	36"	78"	47"	31 1/2"	23 1/4"	9 13/16"	2"	1"	850
TAS-16-F-L	16"	48"	99"	60"	40"	29 1/2"	14 3/4"	2"	1 1/2"	1900
TAS-18-F-L	18"	54"	116"	66"	50"	33"	16 5/8"	2"	1 1/2"	2500
TAS-20-F-L	20"	60"	130"	72"	60"	35"	18 1/8"	2"	1 1/2"	3400
TAS-22-F-L	22"	66"	142"	78"	66"	38"	20 1/8"	2"	1 1/2"	3900
TAS-24-F-L	24"	66"	142"	80"	66"	38"	19 1/2"	2"	1 1/2"	4300

# Cemline® Tangential Air Separators

## Dimensional Drawings

### TAS with Strainer

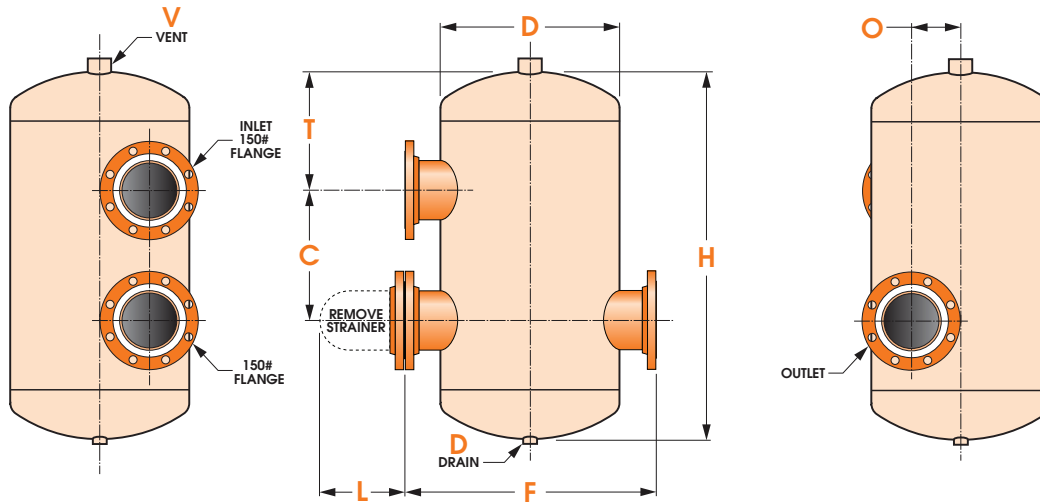

### Dimensional Chart

Model No.	In/Out	D	H	"F" Face to Face	"C" Center to Center	"T" Distance from Top to Center of Inlet	"O" Flange Offset from Center Line	"V" Vent	"D" Drain	"L"	Weight (lbs)
TAS-2-N-S	2"	12"	26"	18"	9"	8 1/2"	3 1/2"	1 1/4"	1"	18"	45
TAS-2.5-N-S	2.5"	12"	26"	18"	9"	8 1/2"	3 1/2"	1 1/4"	1"	18"	50
TAS-3-F-S	3"	12"	26"	20"	9"	8 1/2"	3 1/2"	1 1/4"	1"	18"	80
TAS-4-F-S	4"	14"	30"	21"	10 3/4"	9 5/8"	4 1/4"	1 1/2"	1"	22"	100
TAS-5-F-S	5"	16"	32"	24"	12"	10"	4 3/4"	1 1/2"	1"	22"	135
TAS-6-F-S	6"	20"	41"	28"	14 1/2"	13 1/4"	5 1/2"	2"	1"	26"	235
TAS-8-F-S	8"	24"	52"	32"	18"	17"	6 3/4"	2"	1"	30"	250
TAS-10-F-S	10"	30"	60"	41"	22"	19"	8 7/16"	2"	1"	36"	500
TAS-12-F-S	12"	30"	66"	41"	26"	20"	7 7/16"	2"	1"	36"	650
TAS-14-F-S	14"	36"	78"	47"	31 1/2"	23 1/4"	9 13/16"	2"	1"	42"	900
TAS-16-F-S	16"	48"	99"	60"	40"	29 1/2"	14 3/4"	2"	1 1/2"	54"	2200
TAS-18-F-S	18"	54"	116"	66"	50"	33"	16 5/8"	2"	1 1/2"	60"	2800
TAS-20-F-S	20"	60"	130"	72"	60"	35"	18 1/8"	2"	1 1/2"	66"	3600
TAS-22-F-S	22"	66"	142"	78"	66"	38"	20 1/8"	2"	1 1/2"	72"	4200
TAS-24-F-S	24"	66"	142"	80"	66"	38"	19 1/2"	2"	1 1/2"	72"	4600

### Ordering Code

TAS

TANGENTIAL AIR SEPARATORS

OPENING SIZE

OPENING TYPE

F = Flange  
N = NPT

STRAINER

L = Less Strainer  
S = Strainer

SUPPORT

N = None  
C = Leg Stands  
R = Ring Base  
H = Hanging Bracket

INSULATION THICKNESS

0 = None  
1/2" = 05\*\*  
3/4" = 075\*\*  
1" = 10"  
1 1/2" = 15"  
2" = 20"  
R - 12.5"  
R - 16"  
R - 20"

LOCATION

I = Indoor  
O = Outdoor Coating  
A = Stucco Embossed Aluminum Jacket  
N = No Insulation

\* Insulation for Hot Water - Foam Insulation with removable jacket  
\*\* Insulation for Chilled Water - Elastomeric Insulation

# TAS Series



## Sales Offices

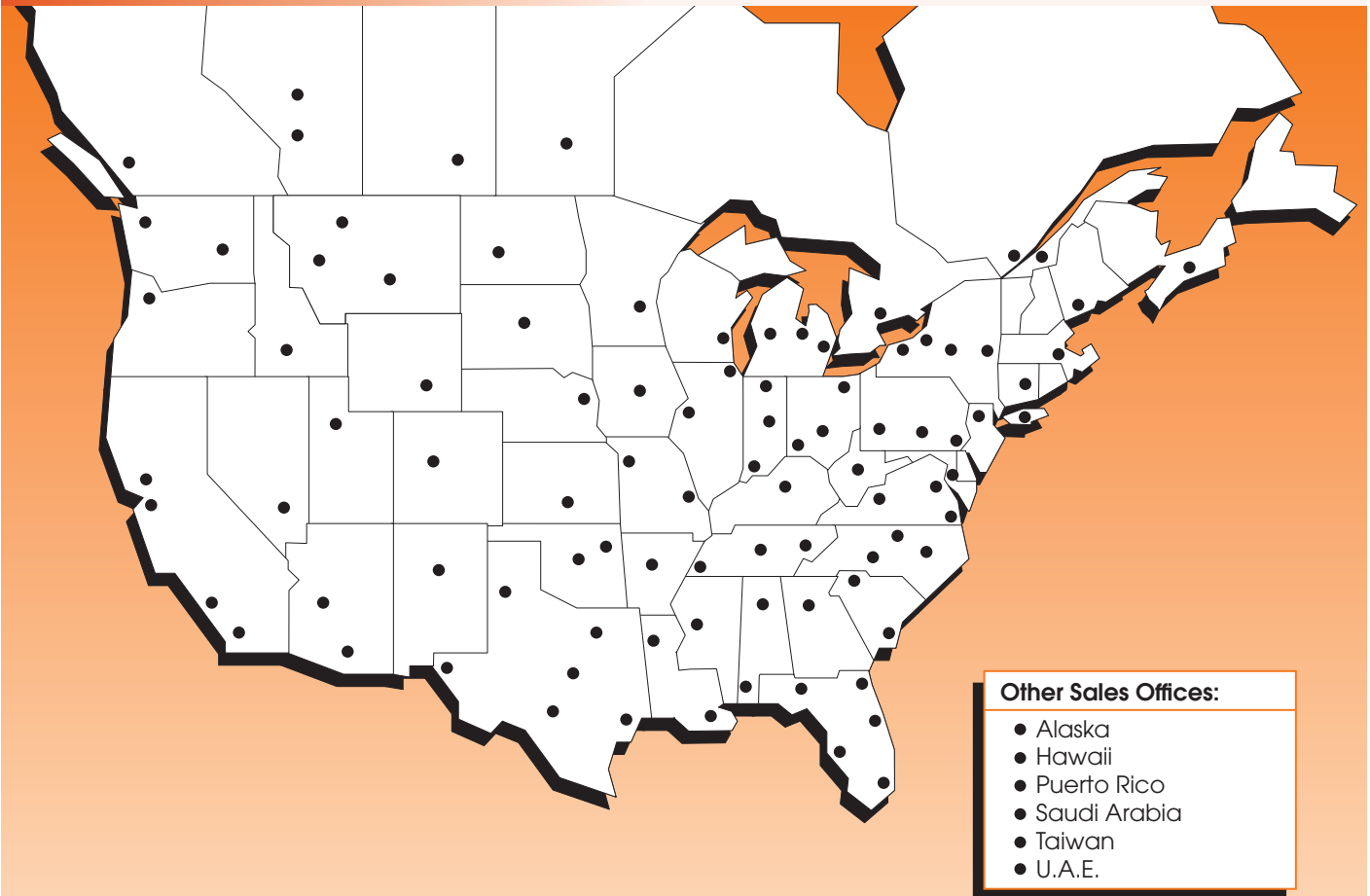

## Available Cemline Brochures



[www.cemline.com](http://www.cemline.com)  
• Product Sizing Programs  
• Brochures  
• I.O.M. Manuals  
• Drawings & Specifications  
• Agent Locator  
• Plant Tour

- STONESTEEL®
  - Water Storage Tanks
  - Jacketed Storage Tanks
  - Commercial Electric and Packaged Copper Coil Water Heaters
- Submerged Heating Coils
- Replacement Tube Bundles
- Steel Tanks
- Chilled Water Buffer Tanks
- System Efficiency Buffer Tanks
- Electric Boilers
- Stainless Compact Packaged Copper Coil Water Heaters - Semi-instantaneous, Instantaneous
- Unfired Steam Generators
- Condensed Catalog

*Cemline is represented in all major cities.  
Please contact your local representative or call Cemline Corporation.*

©2026 Cemline Corporation All Rights Reserved.

All trademarks on this brochure are the property of Cemline Corporation, unless otherwise noted or in any other way set forth as a third party rights. Unauthorized use of these trademarks, as well as the materials presented on this site, is expressly prohibited and constitutes a violation of the intellectual property rights of Cemline Corporation.

Vol. 1.0



Scan to view our mobile web link.

## CEMLINE CORPORATION

P.O. BOX 55 CHESWICK, PENNSYLVANIA 15024  
Phone: (724) 274-5430 FAX: (724) 274-5448

[www.cemline.com](http://www.cemline.com)